

ALBUQUERQUE CONVENTION CENTER

A VERSATILE FACILITY HANDLING GROUPS OF ALL SIZES, THE SMG-MANAGED ALBUQUERQUE CONVENTION CENTER IS NEW MEXICO'S PREMIER MEETING VENUE.

UPPER LEVEL

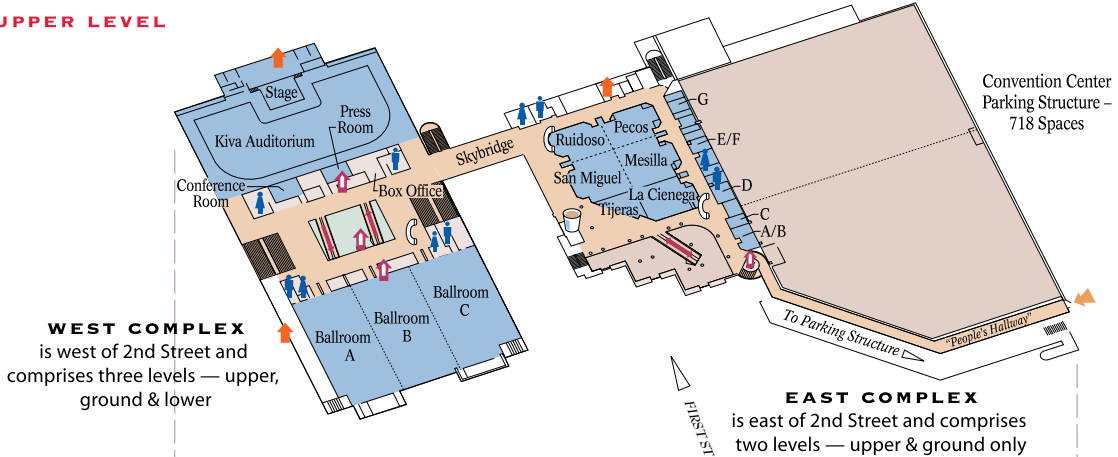

GROUND LEVEL

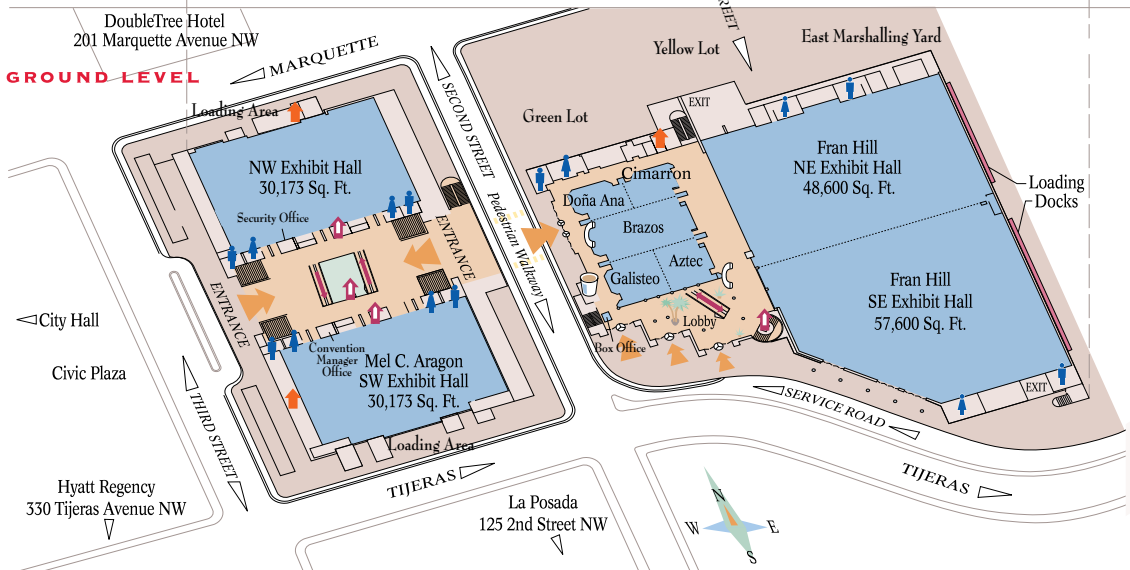

LOWER LEVEL



LEGEND

- Pedestrian Entrance
- Main Passageways
- Rentable Rooms
- Men's Restroom
- Women's Restroom
- Vending
- Courtesy Phones
- Elevator
- Freight Elevator
- Escalator
- Stairs
- Loading Dock
- All areas of the Albuquerque Convention Center are accessible to people with mobility impairments

IT'S A TRIP®
ALBUQUERQUE
CONVENTION & VISITORS BUREAU

WWW.ITSATRIP.ORG/PLANNERS • 1-800-733-9918



Worldwide Entertainment and
Conference Venue Management

Room	ROOM DIMENSIONS		ROOM CAPACITIES			EXHIBIT CAPACITIES
	square feet	size(ft)	theater/ reception	classroom style	banquet seating	10'x10' booths

UPPER LEVEL — Meeting Rooms, Ballrooms, Auditoriums, Support Rooms

Meeting Rooms ceiling height 12'

La Cienega	2,205	49 x 45	162	93	140
Mesilla •	2,940	49 x 60	242	162	160
Pecos •	2,156	49 x 44	130	81	120
Ruidoso •	2,156	49 x 44	130	81	120
San Miguel •	2,940	49 x 60	242	162	160
Tijeras	728	48 x 36 x 32	48	30	48
• Combined	10,192	98 x 104	794	486	480

Ballrooms ceiling height 15'11"

Ballroom A	9,996	68 x 147	642	408	460
Ballroom B	8,880	60 x 147	300	300	320
Ballroom C	12,348	84 x 147	801	544	550
Combined Ballrooms	31,164	211 x 147	2,400	1,360	1,910

Kiva Auditorium angle opera seating for 2,350.

Support Rooms ceiling height 9'10"

East Complex Show Offices

Suite A/B	560	20 x 28
Suite C	300	20 x 15
Suite D	460	20 x 23
Suite E/F	860	20 x 43
Suite G	460	20 x 23

West Complex (outside Kiva Auditorium)

Press Room	560	20 x 28	40	32
Conference Room	400	20 x 20	40	24

GROUND LEVEL — Meeting Rooms, Exhibit Halls

Meeting Rooms ceiling height 13'

Aztec	2,450	50 x 49	180	114	160
Brazos	5,880	60 x 98	462	234	380
Cimarron	1,715	35 x 49	138	75	110
Doña Ana	1,715	35 x 49	138	75	110
Galisteo	2,450	50 x 49	180	114	160
Total Combined	14,210	98 x 145	1,155	648	910

Exhibit Halls prefunction space 5,040 square feet, 140'x36'

NE/SE ceiling height 30' floor to truss, 17' additional to roof. NW ceiling height 16'-20'/SW ceiling height 20'

Northeast	48,600	270 x 180	3,262	1,842	3,080	233
Southeast	57,600	270 x 240	5,170	2,604	3,450	266
NE/SE combined	106,200	270 x 240	9,048	4,566	7,178	503
Northwest	30,173	143 x 211	-	-	-	144
Southwest	30,173	143 x 211	-	-	-	144

LOWER LEVEL — Meeting Rooms

Meeting Rooms ceiling height 10'

Acoma	1,064	28 x 38	71	40	60
Apache	980	35 x 28	49	48	32
Cochiti	1,520	38 x 40	101	72	80
Enchantment I	864	32 x 27	70	36	50
Enchantment II	899	31 x 29	70	36	50
Estancia	680	20 x 34	56	32	30
Isleta	700	35 x 20	47	32	40
Jemez	665	35 x 19	44	32	40
Laguna	972	27 x 36	65	48	60
Nambé	630	35 x 18	42	32	40
Navajo	630	35 x 18	42	32	40
Picuris	2,000	40 x 50	133	100	120
San Juan	567	31 x 27	Fixed seating for 16+	16	
Sandia	880	40 x 22	58	40	50
Santa Ana	1,280	40 x 32	85	60	80
Santo Domingo	837	27 x 31	56	40	50
Taos	2,128	38 x 56	142	120	120
Tesuque	924	28 x 33	62	40	60
Zuni	875	35 x 25	58	32	50
Acoma, Tesuque & Zuni	2,863	28 x 96	191	112	160
Cochiti & Taos	3,648	38 x 96	243	216	230
Picuris, Sandia & Santa Ana	4,160	40 x 104	276	200	260
Isleta & Jemez	1,365	35 x 39	91	64	90
Nambé & Navajo	1,260	35 x 36	84	64	90
Enchantment I & Enchantment II	1,728	64 x 27	110	84	110

CONVENTION CENTER AMENITIES

- Exceptional service from trained professionals
- An on-site preferred audio-visual provider
- Competitive electric rates
- Free Wi-Fi zones in lobby areas
- Convenient on-site business center
- 718 covered parking spaces
- Versatile public areas

QUALITY FOOD SERVICE

- Exclusive on-site food & beverage provider
- Custom menus
- Local and national menus
- Banquet space for up to 6,000
- Personalized service
- Themed events available

VENDOR SERVICES AVAILABLE

- Audio/visual services by PSAV
- Conference recording/duplication
- Event planning
- Exhibit and booth decorators
- Security companies
- Sound/lighting
- Highspeed/wireless internet connectivity

TECHNICAL SPECIFICATIONS

NORTHEAST & SOUTHWEST EXHIBIT HALLS	NORTHWEST & SOUTHWEST EXHIBIT HALLS
Utilities	Utilities
Outer Walls	• Water (hot/cold)
• Water (hot/cold)	• Drains
• Drains	• Gas
• Gas	• Compressed air (limited)
Overhead	Electricity
• Water (hot/cold)	• 120v, 20-100 amps
• Compressed air	• 208v, single phase, 20-100 amps
Electricity	• 208v, three phase, 20-100 amps
• 120v, 20-60 amps	Ceiling Height
• 208v, single phase, 20-60 amps	• 16' - 20'
• 208v, three phase, 20-60 amps	Lights
• 480v, 20-60 amps	• Fluorescent
Ceiling Height - 30'	Floor & Columns
Lights - HID	• Tile over concrete
1,000 watts	• Floor load
& fluorescent	10,000 lbs/wheel or 10 tons/axle
Floor & Columns	• Columns at 25'-30' on center
• Sealed concrete	Loading
• Floor load-unlimited	• Off street
• Column Free	• Overhead doors 16' w x 12' h
Loading & Dock doors	
• 24' w loading dock covered	
• (10) truck bays-one w/ dock leveler	
• Two Dock Doors-22' w x 15' h	
• Five Dock Doors-14' w x 15' h	
Freight Elevator/ Meeting Room Area	NOTE:
• 8' w x 8' h x 16' d	Maximum capacities shown. Capacities subject to change based on staging and audio visual. Classroom set are (4) per 8'x18" table. Banquet set are (10) per 72" round.
• 10,000 lbs capacity	



MarbleStreetStudio.com

“I have been in many places and I just fell in love with Albuquerque and the uniqueness and character of the location.”

Susan Sarfati, CAE
President/CEO,

The Center for Association Leadership & Executive Vice
President, American Society of Association Executives

“The ACVB is a delight to work with. Wonderful people in a great city. They all work well together and provide super support for your event. It was a terrific experience. A million thanks and kudos to all.”

Margaret Reynolds,
Executive Director
Linguistic Society of America

“We truly enjoyed your city. The cultural diversity and opportunity to see many new things was a great draw for our attendees.”

Laura Reicks, RSM
National Association for Treasurers of Religious Institutes

ALBUQUERQUE'S CONVENTION CENTER FEATURES:

- Located in the center of Downtown Albuquerque
- Easy access to Interstates 25 and 40
- 167,562 total square feet of exhibit space (including 106,200 clear-span)
- 2,350-seat auditorium
- 31 meeting rooms
- 31,000-square-foot ballroom
- Capable of handling more than 9,000 attendees
- Banquet space for up to 6,000
- 718 covered parking spaces
- Versatile public areas
- Free Wi-Fi internet access in lobby areas
- Initial meeting room setup at no charge
- An on-site preferred audio-visual provider
- High-speed Internet capability
- Full service business center
- Telephone and data line services
- High-quality food service
- A variety of vendor services
- Over 900 convention-style hotel rooms located within walking distance

